



**BENTLEY**

## CASE STUDY: Bentley Motors, Crewe Factory

### A SHALLOW RAMP GRADIENT TO THE NEW INDUCTION BUILDING

**REQUIREMENT:** A ramp to achieve a 1:20 gradient to the new induction facility at the car factory.

As the name suggests, new trainees will start with a formal induction in this building, before beginning their respective programmes.

**ADDITIONAL INFORMATION:** 1100 high handrails to the level section were also required, in compliance with Document K of the Building Regulations.

Technical and 3D drawings were provided. As illustrated below, the ramp was designed with a shallow incline to joined up with low threshold height of the door.

**Application:** Modular Building

**Location:** Crewe, Cheshire

**System:** Standard Ramp System

**Service Package:** Supply & Install

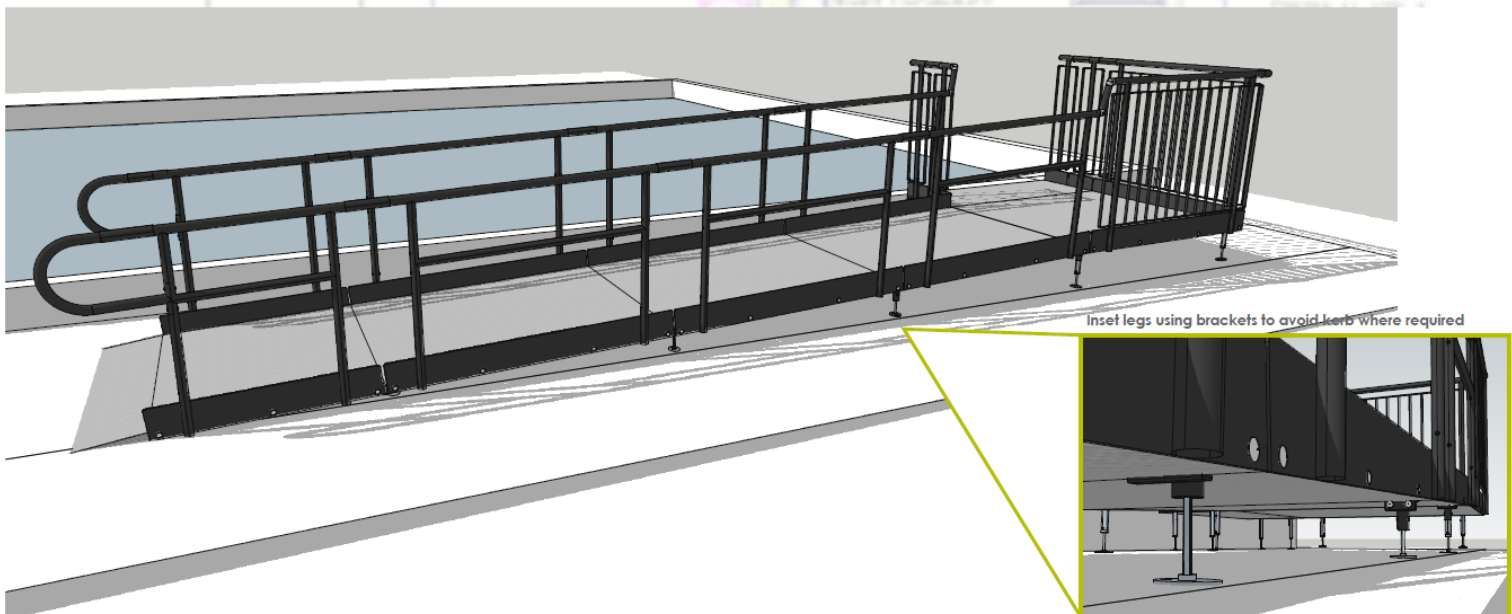

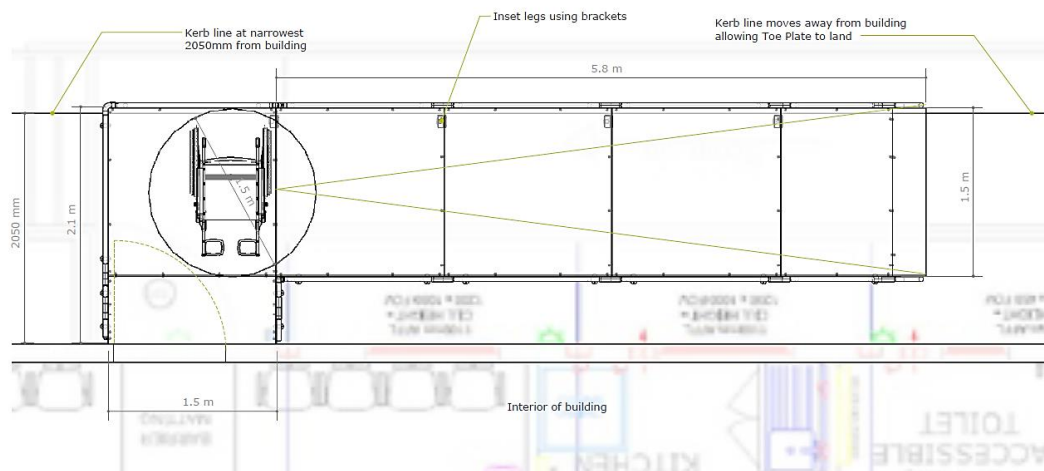

**END RESULT:** A Rapid Ramp was installed and ready to use within a day.

**FEATURES INCLUDED:**

- Trombone Ends - these are added to the ends of a Rapid Ramp to prevent clothes catching.
- Telescopic Legs - these can be adjusted to accommodate different threshold heights.
- Standard Handrail - this handrail is designed to be grasped by the hand, to provide stability or support.
- Mesh Platform - self-draining mesh allows water to pass through rather than collect on the surface.

**EXTRA FEATURE INCLUDED:**

- 1100 High Handrail - these handrails attach to any level sections.



TEL: 01424 714646  
 EMAIL: SALES@RAPIDRAMP.CO.UK

Hours:  
 Open 8am - 5pm, Monday to Friday  
 Address:  
 10 Menzies Road, Ponswood Industrial Estate, St Leonards on Sea, East Sussex TN38 9BB

**Do you require wheelchair access to a modular building?**  
**Contact our sales team**