



CASE STUDY: TAMESIDE HOSPITAL

ACCESS TO A TEMPORARY VACCINATION UNIT

REQUIREMENT: A fully compliant ramp to a temporary ward, supporting the COVID-19 vaccination programme.

ADDITIONAL INFORMATION: CAD and technical drawings were designed in-house and based on-site measurements and architectural drawings.

Application: Healthcare

Location: Tameside, Manchester

System: Fully Compliant Modular Ramp

Service Package: Supply & Install

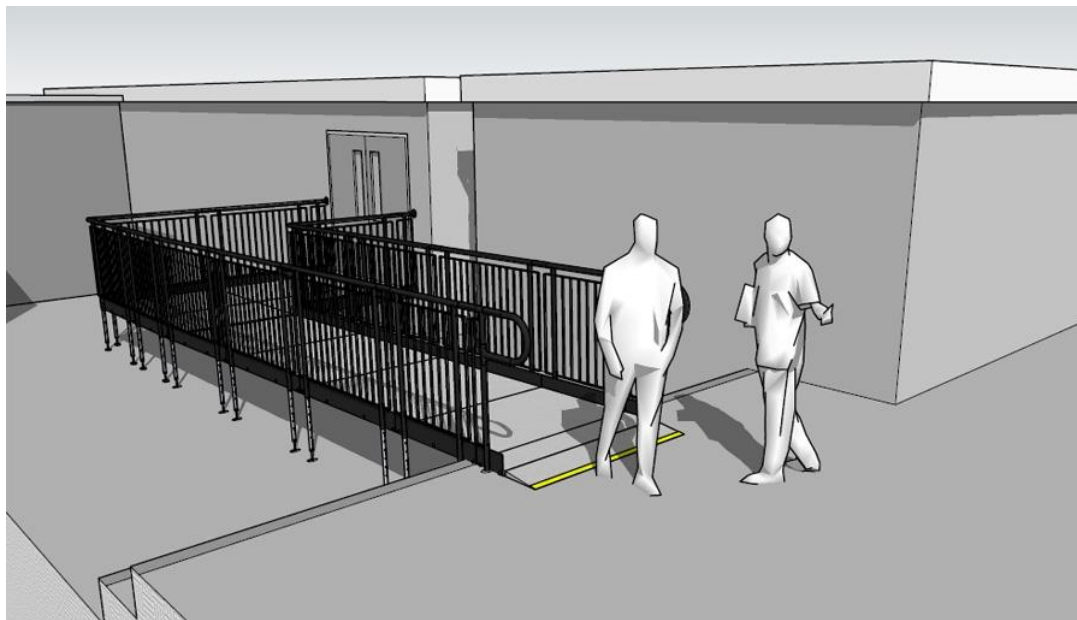

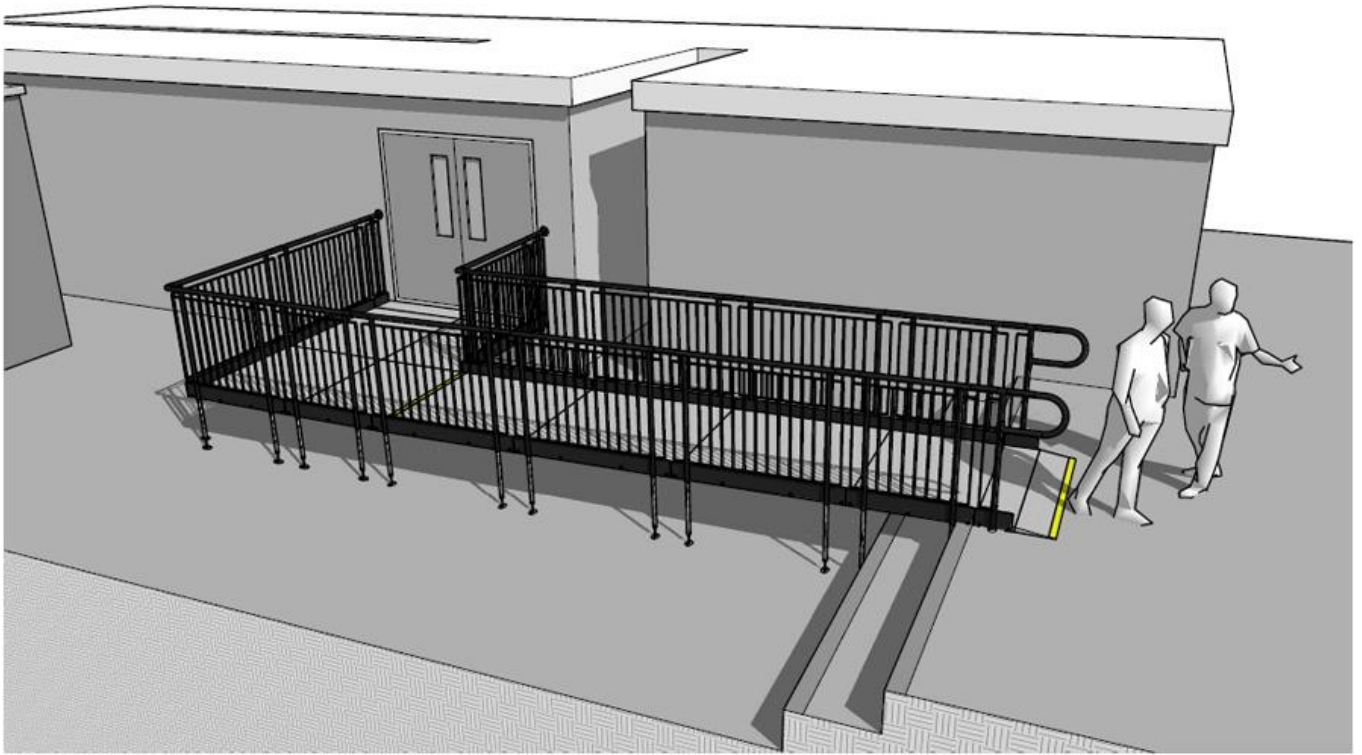

ELEVATION

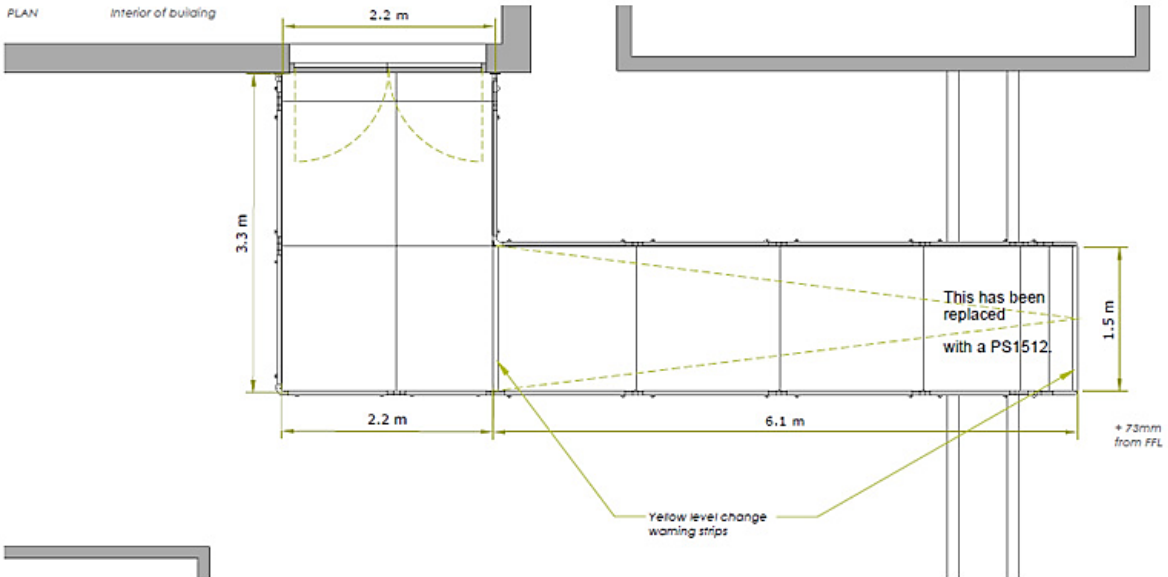
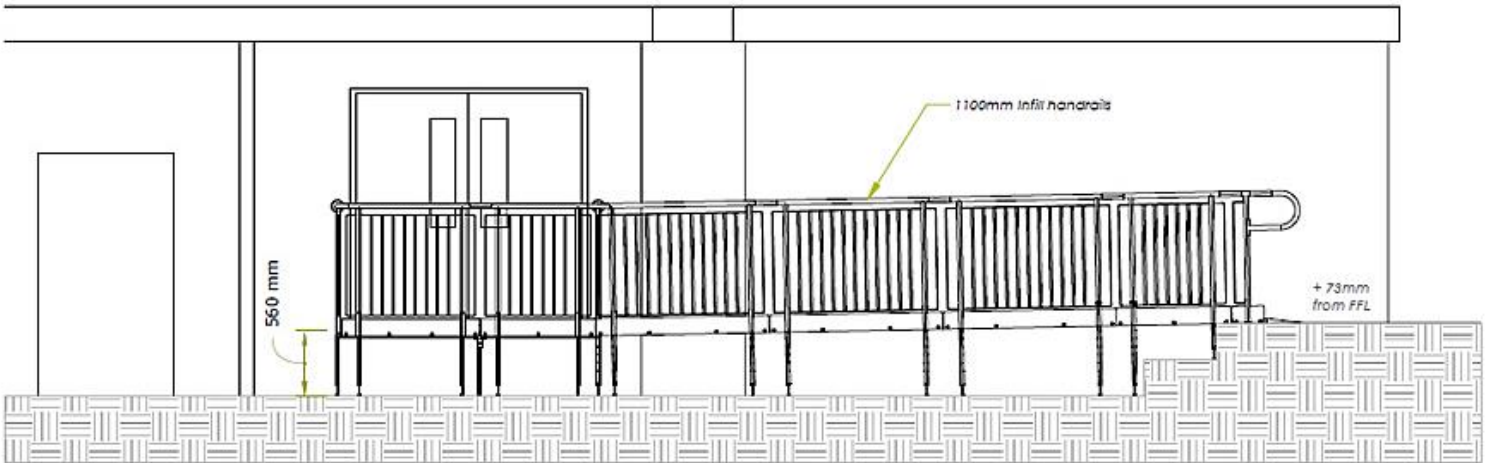

END RESULT: Once the temporary vaccination unit was assembled, we installed a Rapid Ramp compliant with Document M and K of the Building Regulations.

The ramp also overcomes the concrete steps that would have otherwise hindered wheelchair users from accessing the unit.

FEATURES INCLUDED:

- Infill Handrail - this product prevents users from climbing or falling through gaps.
- Yellow Tread - this is a safety feature designed to help those with impaired vision identify the nose of the ramp. Additionally, it helps users distinguish any level changes.
- Trombone Ends - these are added to the ends of a Rapid Ramp to prevent clothes catching.
- Mesh Platform - the self-draining mesh allows water to pass through rather than collect on the surface.
- Rest Platform – a rest platform at 5 metres is required to allow the user to pause.
- 1100mm High Rail – these handrails attach to any level sections.
- Continuous Handrail - this handrail system ensures users always have support to hold onto.





TEL: **01424 714646**
EMAIL: **SALES@RAPIDRAMP.CO.UK**

Hours:
Open 8am - 5pm, Monday to Friday

Address:
10 Menzies Road, Ponswood Industrial Estate, St Leonards on Sea, East Sussex TN38 9BB

Do you require access to a
modular building?

Contact our sales team