



CASE STUDY: St Helier Hospital, Sutton

A ONE-WAY SYSTEM OUT OF THE HOSPITAL

REQUIREMENT: To ensure the hospital remains COVID secure, a one-way system was recently implemented with a new side door near the main entrance.

A modular ramp was required from the door for disabled access.

ADDITIONAL INFORMATION: CAD and technical drawings were designed by our specialist CAD designer in-house along with a quotation.

Application: Healthcare

Location: Sutton, London

System: Standard Ramp System

Service Package: Supply & Install

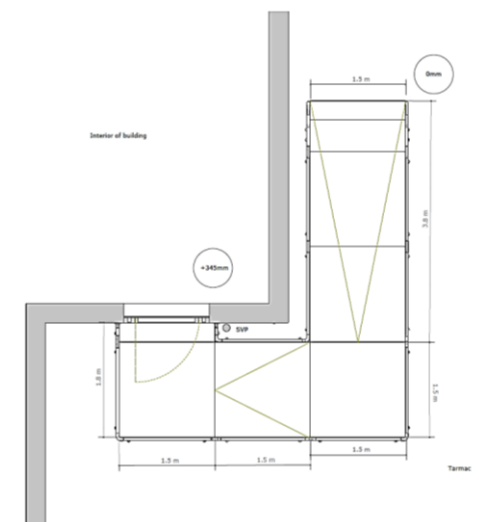



END RESULT: A modular ramp with a 1:15 gradient was installed within a few hours.

Installation was completed very early in the morning, to reduce disturbing the daily running of the hospital.

FEATURES INCLUDED:

- Mesh Platform - self-draining mesh allows water to pass through rather than collect on the surface.
- Trombone Ends - these are added to the ends of a Rapid Ramp to prevent clothes catching.
- Telescopic Legs - these can be adjusted to accommodate different threshold heights.
- Mesh Platform - the self-draining mesh allows water to pass through rather than collect on the surface.

EXTRA FEATURES INCLUDED:

- Infill Handrail - this product prevents users from climbing or falling through gaps.
- Yellow Tread - this is a safety feature designed to help those with impaired vision identify the nose of the ramp and helps users distinguish any level changes.



CREATING A ONE-WAY SYSTEM

A **modular ramp** is ideal in aiding one-way systems in and out of buildings.

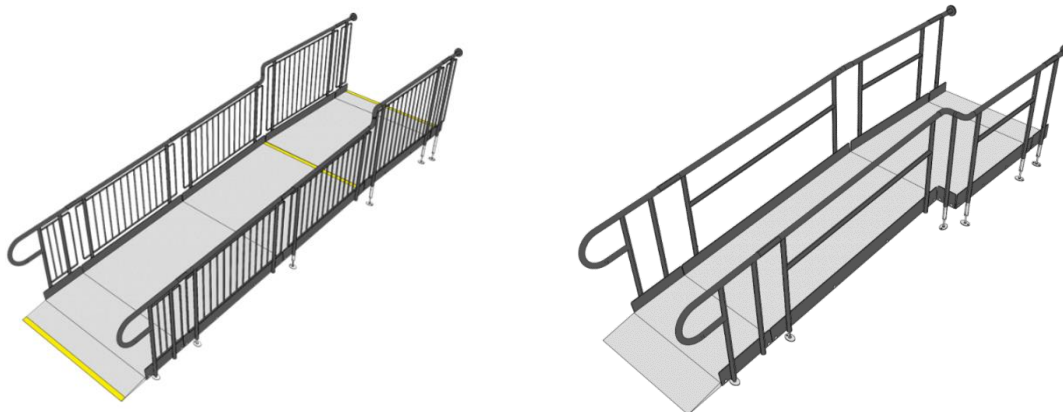

Social Distancing Barriers are also available. They can be erected in a matter of minutes to form two-metre distance queues in car parks, canteen/ till areas and entrances/exits.

Both products are available as a permanent or [hire solution](#).



**Do you have a hospital
that needs disabled
ramps?**

Contact our sales team

TEL: 01424 714646
EMAIL: SALES@RAPIDRAMP.CO.UK

Hours:
Open 8am - 5pm, Monday to Friday

Address:
10 Menzies Road, Ponswood Industrial Estate, St Leonards on Sea, East Sussex TN38 9BB