



CASE STUDY: Decontamination Shower Unit, Blackpool Victoria Hospital

BACKGROUND: A decontamination unit was being built on the rooftop. It will allow personnel who have been exposed to hazardous substances to shower and change.

REQUIREMENT: Ramps to meet the required threshold height and provide access.

Due to the location being exposed to the elements, the ramp would need to withstand impact from all weather conditions, including heavy wind and rain.

The Rapid Ramp System was concluded to be the best solution. It is manufactured from fully galvanised metal for corrosion resistance and has a slip-resistant mesh surface. Plus, all components (excluding the platforms and ramp legs) are powder-coated to create a durable finish.

A wooden ramp was ruled out due to its ability to rot and become slippery in wet weather.

ADDITIONAL INFORMATION: 3D and 2D drawings were created by our designer in-house. These were given to the client with their quotation.

RAMP A, B
FFL 250mm

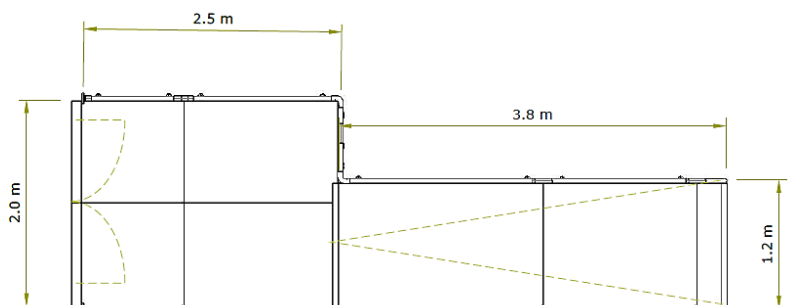

Application: Healthcare

Location: Blackpool, Lancashire

System: Standard Ramp System

Service Package: Supply & Install

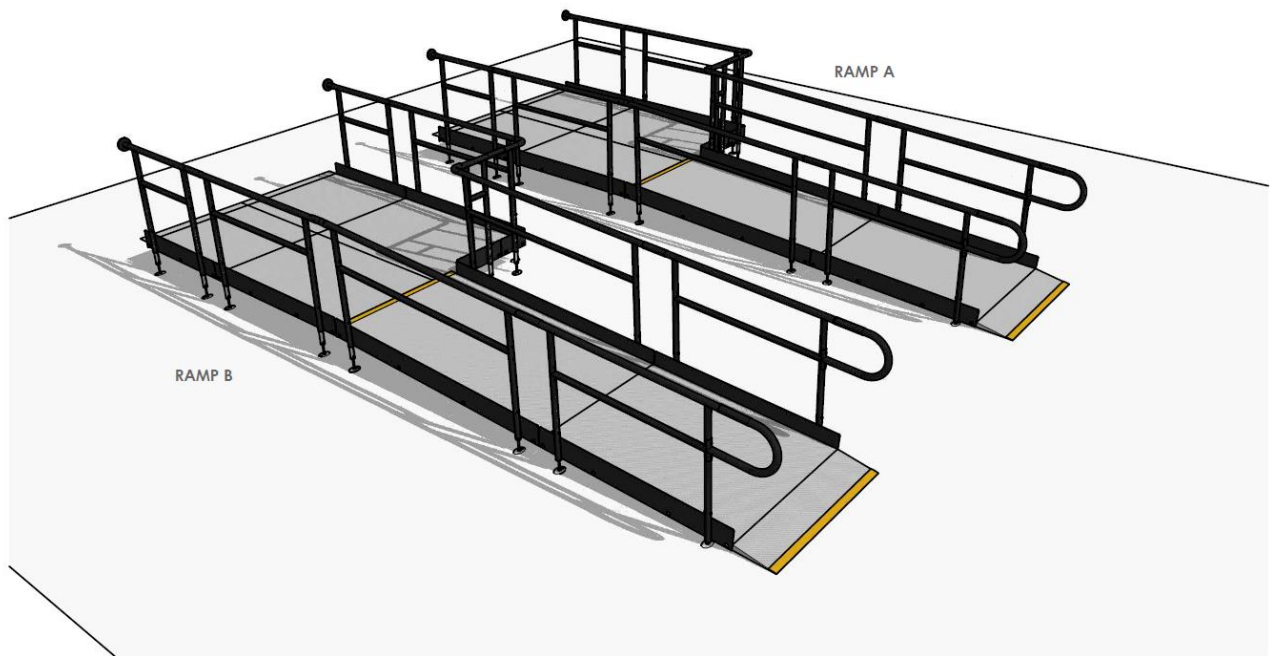

END RESULT: The ramp was installed within a few hours and included a 1:15 gradient.

It wasn't fixed down. The system's weight keeps it in place freestanding, and it has numerous legs to spread the weight load evenly.

Typically, other ramps need to be fixed down to a roof with resin fixings; however, these can fail over time and cause the roof to leak.

Our system came in components that were small enough to be carried in the hospital lifts and onto the roof. This saved the time and cost of a crane lifting the ramps into position.

FEATURES INCLUDED:

- Mesh Platform - the self-draining mesh allows water to pass through rather than collect on the surface.
- Trombone Ends - these are added to the ends of a Rapid Ramp to prevent clothes catching.
- Standard Handrail - this handrail system ensures users always have support to hold onto.
- Powder coated Finish – Rails are coated with thermosetting powder to provide a non-conductive, non-slip and scratch resistant surface.
- Telescopic Legs - these can be adjusted to accommodate different threshold heights.

EXTRA FEATURE INCLUDED:

- Yellow Tread - this is a safety feature designed to help those with impaired vision identify the nose of the ramp and any level changes.



TEL: **01424 714646**
EMAIL: **SALES@RAPIDRAMP.CO.UK**

Hours:
Open 8am - 5pm, Monday to Friday

Address:
10 Menzies Road, Ponswood Industrial Estate, St Leonards on Sea, East Sussex TN38 9BB

Do you require wheelchair ramps and steps?

Contact our sales team