



CASE STUDY: Caravan Steps with Handrails, Finchampstead

Application: Residential

Location: Finchampstead, Wokingham

System: Standard Modular Steps

Service Package: Supply & Install

REQUIREMENT: Caravan steps to match the threshold height of the new UPVC door.

Handrails were necessary to support and maintain the user's balance.

A minimum platform width of 1200mm had to be achieved.

ADDITIONAL INFORMATION: Handrails are included as standard in our modular step kit. CAD drawings were produced from the measurements supplied by our site surveyor.

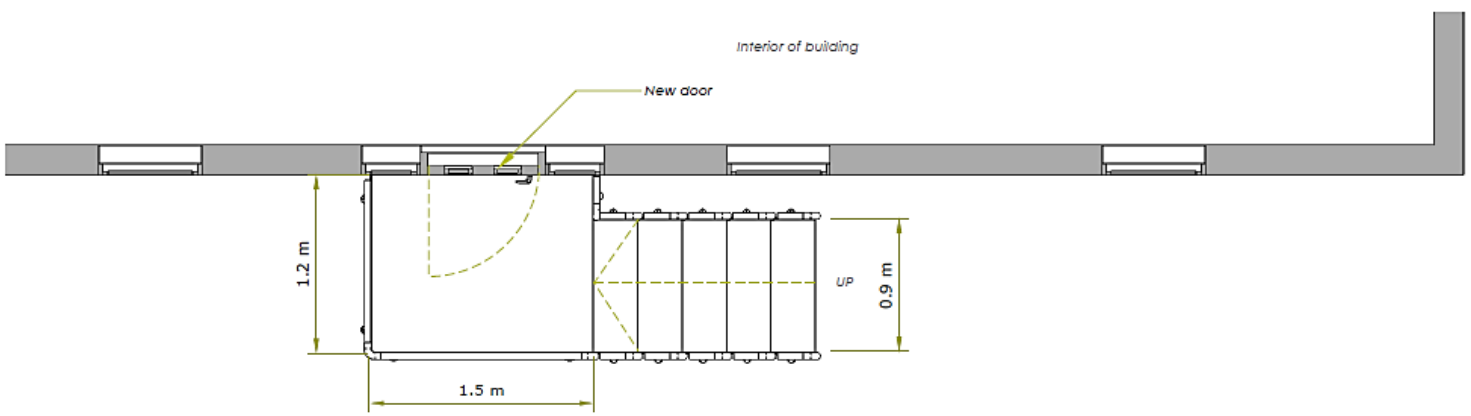



END RESULT: A standard modular step system was installed as shown.

FEATURES INCLUDED:

- Trombone Ends - these are added to the ends of a step system to prevent clothes catching.
- Telescopic Legs - these can be adjusted to accommodate different threshold heights.
- Standard Handrail - this handrail system is designed to be grasped by the hand, to provide stability or support.
- Mesh - self-draining mesh allows water to pass through rather than collect on the surface.





TEL: **01424 714646**
EMAIL: **SALES@RAPIDRAMP.CO.UK**

Hours:
Open 8am - 5pm, Monday to Friday
Address:
10 Menzies Road, Ponswood Industrial Estate, St Leonards on Sea, East Sussex TN38 9BB

Do you require wheelchair
ramps and steps?

Contact our sales team